

- 1.MATERIAL: D-ZLAF52LA(M)  
 2.ASSUME 0.275 BK7 WINDOW FOR LASER DIODE  
 3.NOMINAL PARAMETERS:  
 WAVELENGTH:780 nm  
 NUMERICAL APERTURE:0.40  
 EFFECTIVE FOCAL LENGTH: 6.2mm  
 WORKING DISTANCE: 3.5mm

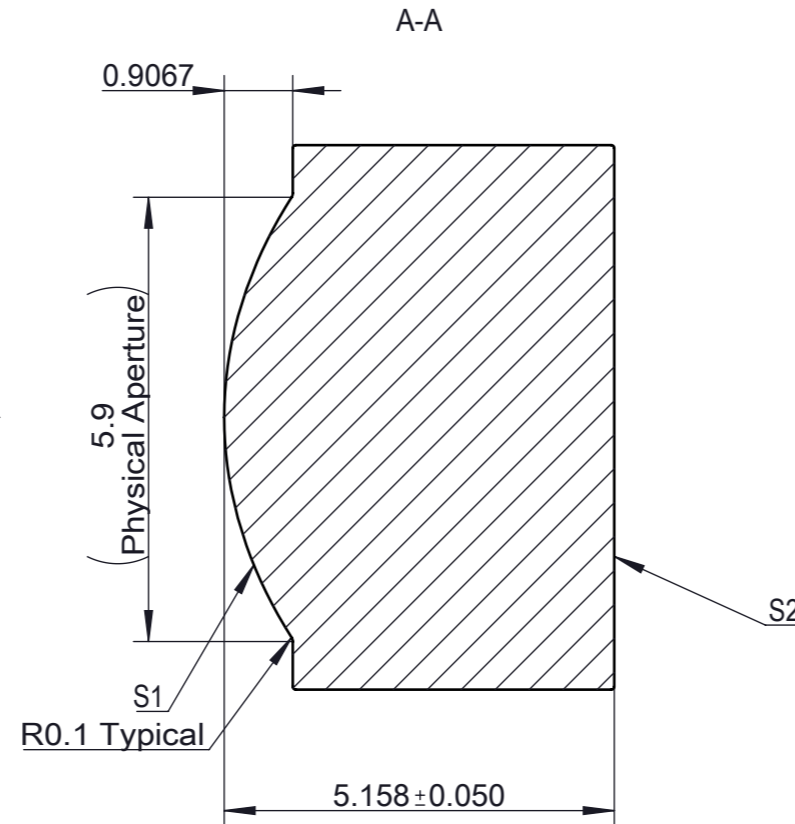
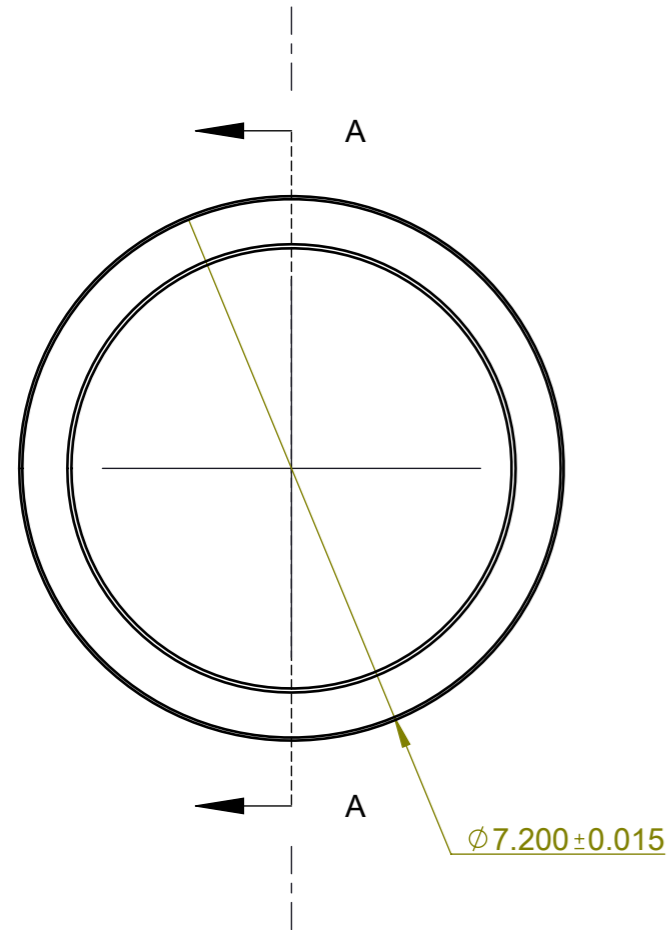

Notes :

1. Evenasphere Formula are defined by :

$$Z(r) = \frac{r^2 / R_c}{1 + \sqrt{1 - (1 + K) (r / R_c)^2}} + \sum_i A_{2i} r^{2i}$$

2. The coefficients are as below :

	S1	S2
R <sub>c</sub>	4.948365	0.000000E+00
K	-0.999999	0.000000E+00
A <sub>2</sub>	0.000000E+00	0.000000E+00
A <sub>4</sub>	4.801386E-004	0.000000E+00
A <sub>6</sub>	1.650447E-006	0.000000E+00
A <sub>8</sub>	-6.988786E-008	0.000000E+00
A <sub>10</sub>	0.000000E0.0	0.000000E+00
A <sub>12</sub>	0.000000E0.0	0.000000E+00
A <sub>14</sub>	0.000000E0.0	0.000000E+00
A <sub>16</sub>	0.000000E0.0	0.000000E+00

3.REQUIREMENT

	S1	S2
Surface quality	S/D 40/20	
Clear Aperture	5.0mm	3.0mm
WFE	RMS<0.070λ@633nm PV<0.270λ@633nm&50%APERTURE	
Roughness	Ra<5nm	

Distributor  
  
 where technologies meet solutions  
 info@amstechnologies.com  
 www.amstechnologies-webshop.com  
 Contact us

Rev	ECO	Notes	Sign	Date
A	01	Initial	Clay	2021/6/15

MATERIAL  
**D-ZLAF52LAM**

UNLESS OTHERWISE SPECIFIED

Unit is MM.

DEFAULT TOLERANCE:

.X ±0.25

.XX ±0.10

.XXX ±0.025

Angles: ±0.5°



光皓光学 (江苏) 有限公司  
 GH Optics(Jiangsu) Co.,Ltd.

图幅 单位 第一视角

A4 公制

LE6240UC-10

A

第 1 张 共 1 张